



# Part number

# CDSF 42



## Brief description:

female insert, 42 poles + PE, spring terminal connections , 10A 400V, 6kV, 3, silver plated, size "104.27", CLASS insert series

Product description		Approvals / Standards	
<b>Model</b>	female insert	<b>Reference standard</b>	EN 61984 (2001-11)
<b>Version</b>	spring terminal connections	<b>Quality mark</b>	  EAC
<b>Series</b>	CDS	<b>Conformity</b>	CQC, CE
<b>Product type</b>	with female contacts	General ordering information	
<b>Family</b>	CLASS inserts	<b>EAN13 code</b>	8015747148535
<b>Size</b>	size "104.27"	<b>Tariff number</b>	85369095
<b>N. of poles</b>	42 poles + 	<b>Country of origin</b>	Made in EU (IT)
Technical data		<b>ETIM classification</b>	EC000438
<b>Current</b>	10 A (A.C. and D.C.)	Packaging Information	
<b>Voltage</b>	400 V	<b>Packaging length</b>	210,00 mm
<b>Rated impulse withstand voltage</b>	6kV	<b>Packaging height</b>	130,00 mm
<b>Pollution degree</b>	3	<b>Packaging width</b>	240,00 mm
<b>Wire cross-section</b>	0,14 mm <sup>2</sup> - 2,50 mm <sup>2</sup>	<b>Packaging weight</b>	4,33 kg
<b>AWG size</b>	26 - 14	<b>Packaging volume</b>	6,55 dm <sup>3</sup>
<b>Operating temperature range (min, max)</b>	-40°C ... +125°C	<b>Packaging description</b>	Carton box
<b>Contacts material</b>	Brass	<b>Packaging quantity</b>	30 Pcs
<b>Contact type</b>	silver plated	<b>Packaging EAN code</b>	8015747152358
<b>Mating cycles</b>	≥ 500	<b>Sub-packaging weight</b>	0,72 kg
<b>IP degree of protection</b>	IP20 without enclosure; IP65/IP66/IP67/IP68 with enclosure	<b>Sub-packaging description</b>	Carton
<b>PE connection type</b>	Screw	<b>Sub-packaging quantity</b>	5 Pcs
<b>PE terminal stripping length</b>	7 mm	<b>Sub-packaging EAN barcode</b>	8015747152365
<b>PE wire cross-section</b>	0,14 - 4 mm <sup>2</sup> ; AWG 20 - 12		
<b>Tightening torque for PE connection</b>	M4: 1,2 Nm, 10,6 lb.in (Ph2 or 1,0x5,5mm )		
Further technical details			
<b>Characteristics according to EN 61984</b>	10A 400V 6kV 3; 10A 400/690V 6kV 2		
<b>Insulation resistance</b>	≥ 10 GΩ		
<b>Contact resistance</b>	≤ 3 mΩ		
<b>Rated voltage according to UL/CSA</b>	600V		
<b>UL 94 flammability rating</b>	V-0		
<b>Main contacts stripping length</b>	6 - 8 mm		
<b>Torque for main contact</b>	M2,5: 0.4 Nm; 3.5 lb.in (0.5 x 3mm )		
<b>Tightening torque for fixing screws</b>	M3: 0.5 Nm; 4.4 lb.in (Ph1 or 0.8x4 mm)		
<b>Weight</b>	144,33 g		

Part number  
**CDSF 42**



Catalogue drawings

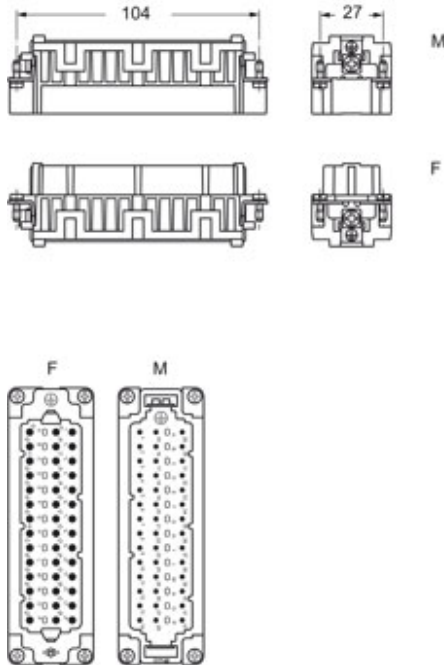

Notes

CDSF/M 42 inserts

- characteristics according to EN 61984:  
10A 400V 6kV 3
- insulation resistance: > 10 GOhm
- ambient temperature limit: -40 °C ... +125 °C
- made of self-extinguishing thermoplastic resin UL 94 V0
- mechanical life: > 500 cycles
- contact resistance: < 1 mOhm
- inserts for conductors section:  
0.14 - 2.5 mm<sup>2</sup> - AWG 26 - 14
- for wires with crimped ferrule, usable section:  
up to 1.5 mm<sup>2</sup> (AWG 16)
- conductors stripping length: 9...11 mm
- enclosures: size 104.27:
- C-TYPE IP65/IP66
- C7 IP67 stainless steel lever
- V-TYPE IP65/IP66 stainless steel lever
- T-TYPE IP65 insulating
- JEI zinc-plated steel lever
- BIG hoods
- W-TYPE for aggressive environment
- EMC
- central lever
- IP68
- LS-TYPE
- panel supports: COB

Connection with spring terminal

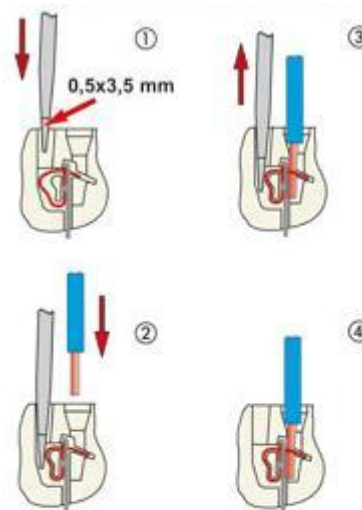

CR CDS coding pin

---